



Floor Mounting Outdoor Panel - IP55



Empty Enclosure IP-65 outdoor

125A Socket IP67



CEE Type Industrial Angled Plug



CEE Type Industrial Plug IP67



CEE Type Industrial Interlocked Socket



Twilight Switch



Presence Sensor



Motion Sensor with Spotlight



Motion Sensor



Floor / Wall Mounting Outdoor Panel IP66



Digital Time Switch

Price List

w.e.f JULY 2017





CAPE manufactures LT Distribution Panel using Glass Fibre Reinforced (GRP) Enclosures for Industrial and Outdoor application. **CAPE** outdoor panel used by various industries all over India. These Panels are available upto IP66 with wall mounting / floor mounting facility. In addition customized high quality enclosures and components from reputed European manufacturers marketed by CAPE are used by various Industries and OEM's / Manufacturers

- Combiner Box and Array Junction Boxes (AJB) for Solar
- MCCB and MCB Distribution boards upto 1250 Amps Incoming
- Industrial CEE type Socket outlet DB's for Outdoor Application / Construction Sites
- Local Control Stations (LCS)
- Feeder Pillar / Street Light control panels

We are the Sole Business partner of the following European manufacturers Providing high quality solution to customers in Indian Market

- M/s Gunther Spelsberg GmbH + Co.KG, Germany
- M/s Theben AG, Germany
- M/s PC Electric GesmbH, Austria
- M/s Uriarte Safybox, Spain

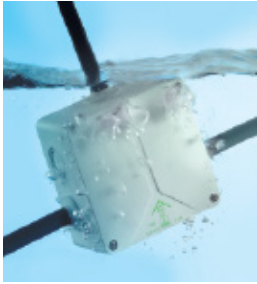

Model	Description	Dimension in mm (L x B x H)	With Terminals		Without Terminals	
			Part No.	Price (Rs)	Part No.	Price (Rs)

Junction Box - IP65 - Thermoplastic Polystyrene

Abox 025	2.5 Sqmm	80 x 80 x 52	802 407 01	365	802 907 01	250
Abox 040	4 Sqmm	93 x 93 x 55	804 407 01	410	804 907 01	295
Abox 060	6 Sqmm	110 x 110 x 67	806 407 01	990	806 907 01	610
Abox 100	10 Sqmm	140 x 140 x 79	810 410 01	1,220	810 910 01	675
TK PS 1818 - 11 m	16 Sqmm	182 x 180 x 111	CJB005PS	1,795	105 907 01	1,110
TK PS 2518 - 11 m	25/35 Sqmm	254 x 180 x 111	CJB006PS	2,520	105 908 01	1,330

Junction Box - IP65 for Outdoor Installation - Thermoplastic Polycarbonate

Abox i 025	2.5 Sqmm	80 x 80 x 52	490 402 01	505	490 902 01	400
Abox i 040	4 Sqmm	93 x 93 x 55	490 404 01	565	490 904 01	475
Abox i 060	6 Sqmm	110 x 110 x 67	490 406 01	1,170	490 906 01	725
Abox i 100	10 Sqmm	140 x 140 x 79	490 410 01	1,485	490 910 01	980
TK PC 1818 - 11 m	16 Sqmm	182 x 180 x 111	CJB005PC	1,850	127 907 40	1,620
TK PC 2518 - 11 m	25/35 Sqmm	254 x 180 x 111	CJB006PC	2,895	127 908 40	1,935

Junction Box - IP55 - Thermoplastic

i 12 L	2.5 Sqmm	85 x 85 x 37			332 912 01	81
i 16 L	2.5 Sqmm	130 x 85 x 37			333 916 01	180
HP 070	2.5 Sqmm	75 x 75 x 42			320 970 01	175
HP 080	2.5 Sqmm	85 x 85 x 42			322 980 01	220
HP 090	4 Sqmm	90 x 90 x 45			325 990 01	275

MCB Distribution Board - IP65 - Thermoplastic Polystyrene with PE & N Terminals

Model	Description	Dimension in mm (L x B x H)	Part No.	Price (Rs)
Ak 03	3 Module	100 x 150 x 96	735 403 01	1,480
Ak 05	5 Module	125 x 200 x 122	735 405 01	1,925
Ak 09	9 Module	200 x 200 x 122	735 409 01	2,280
Ak 12	12 Module	250 x 200 x 122	735 412 01	2,640
Ak 24	24 Module	250 x 370 x 122	735 424 01	5,070
Ak 14	14 Module	300 x 300 x 142	735 414 01	6,755
Ak 28	28 Module	300 x 450 x 142	735 428 01	9,825
Ak 42	42 Module	300 x 600 x 142	735 442 01	11,885
Ak 56	56 Module	300 x 750 x 142	735 456 01	14,145
Ak 70	70 Module	300 x 900 x 142	735 470 01	UR

Model	Description	Dimension in mm (L x B x H)	Part No.	Price (Rs)
-------	-------------	----------------------------------	----------	------------



MCB Distribution Board - IP65 for Outdoor Installation - Thermoplastic Polycarbonate with PE & N Terminals				
Aki 03	3 Module	100 x 150 x 96	736 403 01	1,785
Aki 05	5 Module	125 x 200 x 122	736 405 01	2,350
Aki 09	9 Module	200 x 200 x 122	736 409 01	2,740
Aki 12	12 Module	250 x 200 x 122	736 412 01	3,985
Aki 24	24 Module	370 x 250 x 122	736 424 01	6,285
Aki 14	14 Module	300 x 300 x 142	736 414 01	7,970
Aki 28	28 Module	450 x 300 x 142	736 428 01	11,820
Aki 42	42 Module	600 x 300 x 142	736 442 01	14,315
Aki 56	56 Module	750 x 300 x 142	736 456 01	21,575
Aki 70	70 Module	900 x 300 x 142	736 470 01	UR

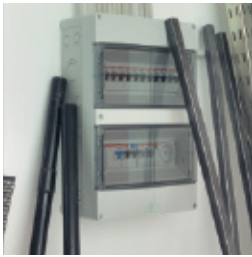

MCB Distribution Board - IP65 for Outdoor Installation - ThermoPlastic ABS without PE & N Terminals				
3902-T	3 Module	100 x 170 x 105	3902-T	1,000
3904-T	4 Module	141 x 217 x 105	3904-T	1,430
3908-T	8 Module	235 x 217 x 105	3908-T	1,610
3912-T	12 Module	307 x 217 x 105	3912-T	1,975



TK Series Empty Enclosure - ThermoPlastic					
Model	Dimension in mm (L x B x H)	Price (Rs) - Polystyrene Indoor		Price (Rs) - Polycarbonate Outdoor	
		Opaque Lid	Transparent Lid	Opaque Lid	Transparent Lid
TK 77 - 8	65 x 65 x 81	530	UR	680	UR
TK 99 - 8	94 x 94 x 81	615	UR	890	UR
TK 1309 - 8	130 x 94 x 81	670	UR	1,025	UR
TK 1313 - 10	130 x 130 x 99	860	UR	1,350	UR
TK 1811 - 11	180 x 110 x 111	860	UR	1,470	UR
TK 1818 - 11	182 x 180 x 111	1,110	1,595	1,620	1,740
TK 2518 - 11	254 x 180 x 111	1,330	1,660	1,935	2,065
TK 3625 - 11	361 x 254 x 111	2,560	3,750	4,495	4,110
TK 3625 - 16	361 x 254 x 165	3,370	UR	5,500	UR



Model	Dimension in mm (L x B x H)	Part No. (With Opaque Lid)	Price (Rs)	Part No. (with Transparent Lid)	Price (Rs)
-------	--------------------------------	----------------------------------	------------	---------------------------------------	------------



Empty Enclosure - IP65 - Thermoplastic Polystyrene - IK07

AkL 1	300 x 150 x 132	740 401 01	2,930	744 001 01	3,205
AkL 2	300 x 300 x 132	740 402 01	3,650	744 002 01	3,785
AkL 3	300 x 450 x 132	740 403 01	4,630	744 003 01	7,095
AkL 4	300 x 600 x 132	740 404 01	6,450	744 004 01	10,875
AkL 2 HighLid	300 x 300 x 210	742 902 01	5,710	746 902 01	UR
AkL 3 HighLid	300 x 450 x 210	742 903 01	7,600	746 903 01	UR
AkL 4 HighLid	300 x 600 x 210	742 904 01	9,420	746 904 01	UR



Empty Enclosure - IP65 for Outdoor Installation - Thermoplastic Polycarbonate - IK08

Aki 1	300 x 150 x 132	741 401 01	3,750	745 001 01	UR
Aki 2	300 x 300 x 132	741 402 01	4,425	745 002 01	5,570
Aki 3	300 x 450 x 132	741 403 01	8,410	745 003 01	7,565
Aki 4	300 x 600 x 132	741 404 01	9,355	745 004 01	9,255
Aki 2 HighLid	300 x 300 x 210	743 902 01	7,025	747 902 01	UR
Aki 3 HighLid	300 x 450 x 210	743 903 01	8,445	747 903 01	8,240
Aki 4 HighLid	300 x 600 x 210	743 904 01	9,690	747 904 01	UR



Empty Enclosure - IP65 for Outdoor Installation - Thermoplastic ABS - IK08

3955	175 x 330 x 130	3955	2,075		
3956	330 x 330 x 130	3956	2,630		
3954	330 x 506 x 130	3954	3,025		



Glass Fiber Reinforced Polyester Enclosure - IP66 IK10 - Outdoor

CA 1515	135 x 135 x 130	CA 1515s	1,615	CA 1515	1,615
CA 215	180 x 135 x 130	CA 215 s	2,040	CA 215	2,040
CA 220	180 x 180 x 130	CA 220 s	2,265	CA 220	2,265
CA 315	270 x 135 x 130	CA 315 s	2,380	CA 315	2,380
CA 32	270 x 180 x 170	CA 32 s	3,060	CA 32	3,060
CA 33	270 x 270 x 170	CA 33 s	3,685	CA 33	3,685
CA 42	360 x 180 x 170	CA 42 s	3,315	CA 42	3,315
CA 43	360 x 270 x 170	CA 43 s	4,425	CA 43	4,425
CA 43a	360 x 270 x 205	CA 43 as	4,755	CA 43a	4,755
CA 44	360 x 360 x 170	CA 44 s	5,375	CA 44	5,375
CA 44a	360 x 360 x 205	CA 44 as	5,565	CA 44a	5,565
CA 63	540 x 270 x 170	CA 63 s	6,875	CA 63	6,875
CA 63a	540 x 270 x 205	CA 63 as	7,480	CA 63a	7,480
CA 64	540 x 360 x 170	CA 64 s	8,410	CA 64	8,410
CA 64a	540 x 360 x 205	CA 64 as	9,315	CA 64a	8,575

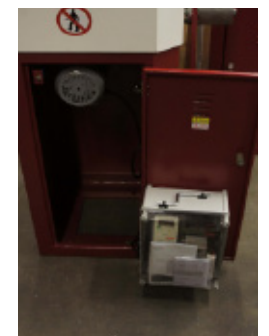



CA 66	540 x 540 x 170	CA 66 s	11,465	CA 66	11,465
CA 66a	540 x 540 x 205	CA 66 as	11,890	CA 66a	9,990
CA 84a	720 x 360 x 205	CA 84 as	11,010	CA 84a	9,380
CA 86a	720 x 540 x 205	CA 86 as	15,365	CA 86a	12,355



Enclosure	Dimension in mm (L x B x H)	Part No. (with Hinged Door)	Price (Rs)	Part No. (With Glazed Hinged Door)	Price (Rs)
-----------	-----------------------------	-----------------------------	------------	------------------------------------	------------

Glass Fiber Reinforced Polyester Enclosure with Hinged Door - IP66 IK10 - Outdoor

BRES - 325	300 x 250 x 140	BRES - 325	5,840	BRES - 325P	7,775
BRES - 43	400 x 300 x 200	BRES - 43	7,520	BRES - 43P	10,395
BRES - 44	400 x 400 x 200	BRES - 44	8,710	BRES - 44P	11,870
BRES - 54	500 x 400 x 200	BRES - 54	10,615	BRES - 54P	15,385
BRES - 64	600 x 400 x 230	BRES - 64	12,205	BRES - 64P	17,000
BRES - 65	600 x 500 x 230	BRES - 65	13,810	BRES - 65P	18,425
BRES - 83	800 x 300 x 230	BRES - 83	19,455	BRES - 83P	24,395
BRES - 86	800 x 600 x 300	BRES - 86	21,975	BRES - 86P	30,875



Glass Fiber Reinforced Polyester Enclosure with Hinged door & 3 Point Locking - IP66 IK10 - Outdoor

BRES - 43	400 x 300 x 200	BRES - 43 - 3L	9,330	BRES - 43P - 3L	12,205
BRES - 44	400 x 400 x 200	BRES - 44 - 3L	10,520	BRES - 44P - 3L	13,680
BRES - 54	500 x 400 x 200	BRES - 54 - 3L	12,420	BRES - 54P - 3L	17,190
BRES - 64	600 x 400 x 230	BRES - 64 - 3L	15,220	BRES - 64P - 3L	20,010
BRES - 65	600 x 500 x 230	BRES - 65 - 3L	16,825	BRES - 65P - 3L	21,435
BRES - 83	800 x 300 x 230	BRES - 83 - 3L	22,470	BRES - 83P - 3L	27,405
BRES - 86	800 x 600 x 300	BRES - 86 - 3L	25,595	BRES - 86P - 3L	34,490



Description	Dimension in mm (L x B x H)	Part No.	Price (Rs)
-------------	-----------------------------	----------	------------

Glass Fiber Reinforced Polyester Feeder Pillar with Hinged door - IP55 IK10 - Outdoor

Feeder Pillar - 500 High Enclosure	500 x 500 x 300	ART - 55	21,925
Feeder Pillar - 750 High Enclosure	750 x 500 x 300	ART - 75	26,750
Feeder Pillar - 1000 High Enclosure	1000 x 500 x 300	ART - 105	28,270
Feeder Pillar - 500 High Enclosure	500 x 750 x 300	ART - 57	26,785
Feeder Pillar - 750 High Enclosure	750 x 750 x 300	ART - 77	31,380
Feeder Pillar - 1000 High Enclosure	1000 x 750 x 300	ART - 107	37,535



Floor Mounted Pedestal for Glass Fiber Reinforced Polyester Feeder Pillar - Outdoor

Polyester Pedestal - 500 h	500 x 500 x 300	F0 - 500	18,045
Polyester Pedestal - 500 h	500 x 750 x 300	F0 - 750	20,830
Polyester Pedestal - 750 h	750 x 500 x 300	F1 - 500	21,280
Polyester Pedestal - 750 h	750 x 750 x 300	F1 - 750	24,065

Polyester Pedestal - 1000 h	1000 x 500 x 300	F2 - 500	22,630
Polyester Pedestal - 1000 h	1000 x 750 x 300	F2 - 750	25,605

Description	Part No.	Price (Rs)
-------------	----------	------------

Accessories

Blind lid Full open 2 for CA Enclosure	TC - 02 - cj	1,000
Blind lid Full open 3 for CA Enclosure	TC - 03 - cj	1,105
Blind lid Full open 4 for CA Enclosure	TC - 04 - cj	1,345
Connecting Flange open 2 - for CA	BA - 20 - cj	850
Connecting Flange open 3 - for CA	BA - 30 - cj	970
Connecting Flange open 4 - for CA	BA - 40 - cj	1,195
Extension Frame CA - 63	RE - 63	10,390
Extension Frame CA - 64	RE - 64	11,880
Extension Frame CA - 66	RE - 66	19,390
External Rigid Hinge 2	bo - BRE - EXT	1,285
External Flexible Hinge 2	BFE	325
Small Ventilation Seal	DV - M	80
Large Ventilation Seal	DV - G	265
Connecting Flange - for BRES	UA 230 x 100	735
Connecting Flange - for BRES	UA 350 x 150	870
Connecting Flange - for BRES	UA 350 x 150 - B	870
Wall Fastening Lug	OFM - 140	475



Amps	Number of Poles	Ref Hours	Rated Voltage	IP44	Price (Rs)	IP67	Price (Rs)
------	-----------------	-----------	---------------	------	------------	------	------------

Trailing Plug - CEE Type							
16A	2P + E	6h	200 - 250 V	013 - 6	255	0132 - 6	635
	3P + E	6h	380 - 415 V	014 - 6	365	0142 - 6	710
	3P + N + E	6h	380 - 415 V	015 - 6	380	0152 - 6	790
32A	2P + E	6h	200 - 250 V	023 - 6	470	0232 - 6	940
	3P + E	6h	380 - 415 V	024 - 6	520	0242 - 6	1,020
	3P + N + E	6h	380 - 415 V	025 - 6	545	0252 - 6	1,055
63A	2P + E	6h	200 - 250 V	0331 - 6	2,430	033 - 6	2,760
	3P + E	6h	380 - 415 V	0341 - 6	2,510	034 - 6	2,835
	3P + N + E	6h	380 - 415 V	0351 - 6	2,580	035 - 6	2,680
125A	2P + E	6h	200 - 250 V	-	-	043 - 6	8,250
	3P + E	6h	380 - 415 V	-	-	044 - 6	8,315
	3P + N + E	6h	380 - 415 V	-	-	045 - 6	7,375

Trailing Socket - CEE Type							
16A	2P + E	6h	200 - 250 V	213 - 6	440	2132 - 6	1,020
	3P + E	6h	380 - 415 V	214 - 6	520	2142 - 6	-
	3P + N + E	6h	380 - 415 V	215 - 6	540	2152 - 6	1,195
32A	2P + E	6h	200 - 250 V	223 - 6	605	2232 - 6	1,365
	3P + E	6h	380 - 415 V	224 - 6	730	2242 - 6	-
	3P + N + E	6h	380 - 415 V	225 - 6	740	2252 - 6	1,455
63A	2P + E	6h	200 - 250 V	2331 - 6	3,060	233 - 6	3,660
	3P + E	6h	380 - 415 V	2341 - 6	-	234 - 6	-
	3P + N + E	6h	380 - 415 V	2351 - 6	3,525	235 - 6	4,115
125A	2P + E	6h	200 - 250 V	-	-	243 - 6	-
	3P + E	6h	380 - 415 V	-	-	244 - 6	-
	3P + N + E	6h	380 - 415 V	-	-	245 - 6	9,865

Flush Mounted Panel Socket - Straight - CEE Type							
16A	2P + E	6h	200 - 250 V	313 - 6	385	3132 - 6	740
	3P + E	6h	380 - 415 V	314 - 6	545	3142 - 6	785
	3P + N + E	6h	380 - 415 V	315 - 6	555	3152 - 6	810
32A	2P + E	6h	200 - 250 V	323 - 6	585	3232 - 6	990
	3P + E	6h	380 - 415 V	324 - 6	670	3242 - 6	1,050
	3P + N + E	6h	380 - 415 V	325 - 6	690	3252 - 6	1,095
63A	2P + E	6h	200 - 250 V	3331 - 6	2,310	333 - 6	2,950
	3P + E	6h	380 - 415 V	3341 - 6	2,375	334 - 6	2,985
	3P + N + E	6h	380 - 415 V	3351 - 6	2,440	335 - 6	3,055

Amps	Number Of Poles	Ref Hours	Rated Voltage	IP44	Price (Rs)	IP67	Price (Rs)
125A	2P + E	6h	200 - 250 V	-	-	343-6	8,360
	3P + E	6h	380 - 415 V	-	-	344-6	8,975
	3P + N +E	6h	380 - 415 V	-	-	345-6	9,055



Flush Mounted Panel Socket - Angled - CEE Type

16A	2P + E	6h	200 - 250 V	413 - 6f8	415	4132 - 6f8	740
	3P + E	6h	380 - 415 V	414 - 6f8	575	4142 - 6f8	825
	3P + N +E	6h	380 - 415 V	415 - 6	555	4152 - 6f8	810
32A	2P + E	6h	200 - 250 V	423 - 6	585	4232 - 6f8	990
	3P + E	6h	380 - 415 V	424 - 6	670	4242 - 6f8	1,050
	3P + N +E	6h	380 - 415 V	425 - 6	690	4252 - 6f8	1,095
63A	2P + E	6h	200 - 250 V	4331 - 6f8	2,310	433 - 6f8	2,950
	3P + E	6h	380 - 415 V	4341 - 6f8	2,375	434 - 6f8	2,985
	3P + N +E	6h	380 - 415 V	4351 - 6f8	2,440	435 - 6f8	3,060
125A	2P + E	6h	200 - 250 V	-	-	443 - 6	8,860
	3P + E	6h	380 - 415 V	-	-	444 - 6	8,975
	3P + N +E	6h	380 - 415 V	-	-	445 - 6	7,090



Interlocked Socket - CEE Type

16A	2P + E	6h	200 - 250 V	7513 - 6	6,805	75132 - 6	6,240
	3P + E	6h	380 - 415 V	7514 - 6	7,090	75142 - 6	6,520
	3P + N +E	6h	380 - 415 V	7515 - 6	7,375	75152 - 6	8,505
32A	2P + E	6h	200 - 250 V	7523 - 6	7,090	75232 - 6	7,655
	3P + E	6h	380 - 415 V	7524 - 6	7,375	75242 - 6	8,505
	3P + N +E	6h	380 - 415 V	7525 - 6	7,655	75252 - 6	9,355
63A	2P + E	6h	200 - 250 V	-	-	75332 - 6	15,880
	3P + E	6h	380 - 415 V	-	-	75342 - 6	16,730
	3P + N +E	6h	380 - 415 V	-	-	75352 - 6	17,860
125A	2P + E	6h	200 - 250 V	-	-	9755102	86,750
	3P + E	6h	380 - 415 V	-	-	9755099	87,320
	3P + N +E	6h	380 - 415 V	-	-	9755100	64,075



Interlocked Socket with DIN-Rail - CEE Type

16A	2P + E	6h	200 - 250 V	7613 - 6	8,505	76132 - 6	10,775
	3P + E	6h	380 - 415 V	7614 - 6	8,790	76142 - 6	10,775
	3P + N +E	6h	380 - 415 V	7615 - 6	9,075	76152 - 6	11,340
32A	2P + E	6h	200 - 250 V	7623 - 6	10,206	76232 - 6	11,680
	3P + E	6h	380 - 415 V	7624 - 6	11,060	76242 - 6	11,910
	3P + N +E	6h	380 - 415 V	7625 - 6	10,775	76252 - 6	11,340



Amps	Number Of Poles	Ref Hours	Rated Voltage	IP44	Price (Rs)	IP67	Price (Rs)
63A	2P + E	6h	200 - 250 V	76331 - 6	-	76332 - 6	27,220
	3P + E	6h	380 - 415 V	76341 - 6	-	76342 - 6	27,785
	3P + N + E	6h	380 - 415 V	76351 - 6	-	76352 - 6	28,350



Socket with DIN Rail - CEE Type							
16A	2P + E	6h	200 - 250 V	75133 - 6	5,670	751323 - 6	5,950
	3P + E	6h	380 - 415 V	75143 - 6	-	751423 - 6	-
	3P + N + E	6h	380 - 415 V	75153 - 6	6,520	751523 - 6	6,805
32A	2P + E	6h	200 - 250 V	75233 - 6	9,075	752323 - 6	9,355
	3P + E	6h	380 - 415 V	75243 - 6	-	752423 - 6	-
	3P + N + E	6h	380 - 415 V	75253 - 6	10,290	752523 - 6	10,490



Wall mounted Socket - CEE Type							
16A	2P + E	6h	200 - 250 V	113 - 6	710	1132 - 6	1,365
	3P + E	6h	380 - 415 V	114 - 6	-	1142 - 6	-
	3P + N + E	6h	380 - 415 V	115 - 6	825	1152 - 6	1,535
32A	2P + E	6h	200 - 250 V	123 - 6	825	1232 - 6	1,590
	3P + E	6h	380 - 415 V	124 - 6	-	1242 - 6	-
	3P + N + E	6h	380 - 415 V	125 - 6	935	1252 - 6	1,760



Schuko Plug & Socket							
16A	2P + E	-	200 - 250 V	Schuko Socket		1050-0b	330
		-	200 - 250 V	Schuko Plug		02958	175
		-	200 - 250 V	Schuko Rubber Plug		0511-s	285
		-	200 - 250 V	Schuko Rubber Connector		2510-s	530
		-	200 - 250 V	Schuko Rubber Connector with Cap		2511-s	585



Interlocked Socket IP67 - Horizontal - CEE Type						
16A	2P + E	6h	200 - 250 V	25108	2,565	
	3P + E	6h	380 - 415 V	25109	2,815	
	3P + N + E	6h	380 - 415 V	25110	3,085	
32A	2P + E	6h	200 - 250 V	25111	2,745	
	3P + E	6h	380 - 415 V	25112	3,025	
	3P + N + E	6h	380 - 415 V	25113	3,325	





Program	No of Channels	Power Reserve	Programmable Every	Operating Voltage	Type	Part No.	Price (Rs)
Analogue Time Switches							
Daily	1	200 hours	15 min	230 V AC	SUL 181 d	1810011	3,755
	1	3 Days	15 min	230 V AC	SUL 189 s	1890801	6,465



Digital Time Switches							
Weekly	1	10 Years	1 Min	230V AC	TR 610 top 2	6100103	5,365
	2	10 Years	1 Min	230V AC	TR 612 top 2	6120103	11,010
	1	10 Years	1 Sec	230V AC	TR 611 top 2	6110103	13,005
	2	10 Years	1 Sec	230V AC	TR 622 top 2	6220103	16,560
Yearly	1	8 Years	1 Min	230V AC	TR 641 top 2	6410100	30,970
	2	8 Years	1 Min	230V AC	TR 642 top 2	6420100	32,820
	4	8 Years	1 Min	230V AC	TR 644 top 2	6440100	34,780



Digital Yearly Time Switches with DCF \ GPS Provision							
Yearly	1	8 Years	1 Min	230V AC	TR 641 top 2 RC	6410300	31,860
	2	8 Years	1 Min	230V AC	TR 642 top 2 RC	6420300	42,085
	4	8 Years	1 Min	230V AC	TR 644 top 2 RC	6440300	52,820



Astronomical Time Switches							
Weekly	1	10 Years	1 Min	230V AC	SELEKTA 170 top 2	1700100	7,055
	2	10 Years	1 Min	230V AC	SELEKTA 172 top 2	1720100	16,595



Setting Range	Switch On Delay	Sensor Mounting	Protection Rating	Operating Voltage	Type	Part No.	Price (Rs)
Twilight Switches - Analogue							
2 - 2000 Lux	60 s	Surface	IP20, Sensor IP55	230V AC	LUNA 109 AL	1090100	10,485
		Flush	IP20, Sensor IP55	230V AC	LUNA 109 EL	1090200	10,485
2 - 50000 Lux	0 - 20 Min	Surface	IP20, Sensor IP55	230V AC	LUNA 110 AL	1100100	11,375
		Flush	IP20, Sensor IP55	230V AC	LUNA 110 EL	1100200	11,375

Twilight Switches - Integrated							
5 - 200 Lux	40s	Integrated	IP55	230V AC	LUNA 126 Star	1260700	4,780
2 - 200 Lux	2 - 100s	Integrated	IP55	230V AC	LUNA 127 Star	1270700	6,740
2 - 2000 Lux	2 - 100s	Integrated	IP55	230V AC	LUNA 128 Star	1280700	7,050



No of Channels	Setting Range	Switch On Delay	Protection Rating	Operating Voltage	Type	Part No.	Price (Rs)
Twilight Switches - Digital							
1	1 - 99000 Lux	0 - 59 Min	Surface	230V AC	LUNA 111 top 2 AL	1110100	19,590
			Flush	230V AC	LUNA 111 top 2 EL	1110200	21,365
2	1 - 99000 Lux	0 - 59 Min	Surface	230V AC	LUNA 112 top 2 AL	1120100	29,115
			Flush	230V AC	LUNA 112 top 2 EL	1120200	32,270



Detection Angle \ Channel	Detection Range	Light Switch off Delay	Operating Voltage	Type	Part No.	Price (Rs)
Motion Detectors - LUXA Range						
150° / Light	12 m	5 s - 12 min	230 V	theluxa S 150	1010500	4,055
180° / Light	12 m	5 s - 12 min	230 V	theluxa S 180	1010505	4,370
360° / Light	32 m	5 s - 12 min	230 V	theluxa S 360	1010510	8,570



Motion Detectors - With Spot Light						
140° / Light	10 m	5 s - 10 min	230 V	Luxa 102 - 140 LED 8w WH	1020971	10,795
140° / Light	10 m	5 s - 10 min	230 V	Luxa 102 - 140 LED 8w BK	1020972	10,795
140° / Light	10 m	5 s - 10 min	230 V	Luxa 102 - 140 LED 16w WH	1020973	16,190
140° / Light	10 m	5 s - 10 min	230 V	Luxa 102 - 140 LED 16w BK	1020974	16,190



Motion Detectors - Mova Range						
360° / Light	8m	10s - 60 min	230 V	theMova S360 100 DE WH	1030560	11,645
360° / Light / Presence	8m	10s - 60 min	230 V	theMova S360 101 AP WH	1030555	10,980
360° / Light / Presence	8m	10s - 60 min	230 V	theMova S360 101 DE WH	1030565	10,550



Presence Detectors						
360° / Light / Presence	6m x 6m	10s - 60 min	230 V	thePrema S 360 - 101	2070505	25,110
360° / Light / Presence	8m	10s - 60 min	230 V	the Ronda P360 - 101	2080005	30,435



Accessories						
Description	Suitable For	Type	Part No.	Price (Rs)		
OBELISK top 2 Memory Card, USB Plug in Adapter	TR top 2, LUNA top 2, SELEKTA top 2	OBELISK top 2 PC Set	9070409	14,675		
Individual Memory Card	TR top 2, LUNA top 2, SELEKTA top 2	Memory Card OBELISK top 2	9070404	2,925		
RC Filter for Presence and Motion Detector	All Presence, Motion Detectors	RC Filter	9070523	2,555		
Surface - Mounted Light Sensor, IP54, Rotating Sensor	LUNA 108	Surface Mounted light Sensor IP54	9070008	3,735		
Analogue Surface - Mounted Light Sensor, IP55, Rotating Sensor	LUNA 108, LUNA 109 LUNA 110	Analogue Surface Mounted Light Sensor IP55	9070416	3,935		
Digital Surface - Mounted Light Sensor, IP55, Rotating Sensor	LUNA 111 top2, LUNA 112 top2	Surface Mounted Light Sensor	9070415	9,050		
Analogue Flush - Mounted Light Sensor IP65, 1.5m ConnectingCable	LUNA 108, LUNA 109 LUNA 110	Analogue Flush Mounted Light Sensor IP55	9070011	4,950		
Digital Flush - Mounted Light Sensor IP65, 1.5m ConnectingCable	LUNA 111 top2, LUNA 112 top2	Flush Mounted Light Sensor	9070456	11,835		

Local Control Station - LCS

CAPE LCS are made with Spelsberg Polycarbonate / Polystyrene enclosures. The Enclosures are surface mounting type, IP66. LCS are Compact in size, UV resistant and are suitable for Outdoor application. The knock out provision available for 4 sides of the LCS ensure cable entry through all the sides. Enclosures are completely double insulated to meet industrial safety regulations and are suitable to operate upto 230 V

Emergency STOP Push Button

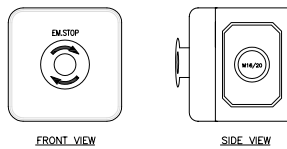

FRONT VIEW

SIDE VIEW

65 (W) x 65 (H) x 57 (D) mm

Mushroom Head STOP Push Button with Push to Lock and Turn to Release with 1NC Contact

	Part No.	Price (Rs)
Outdoor	CLCS 001	1,160
Indoor	CLCS 002	1,095

START - Emergency STOP Push Button

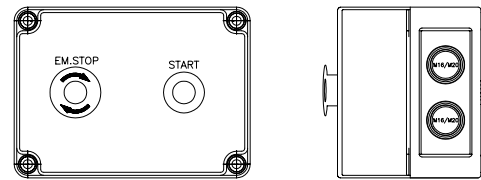

FRONT VIEW

SIDE VIEW

130 (W) x 94 (H) x 81 (D) mm

Green Actuator flush Head with 1 NO "Start" + Mushroom Head push button push to Lock and Turn to Release with 1 NC Contact

	Part No.	Price (Rs)
Outdoor	CLCS 016	2,190
Indoor	CLCS 017	1,610

Emergency STOP with KEYLOCK

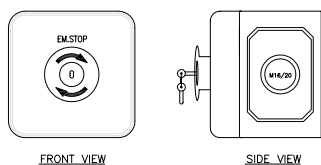

FRONT VIEW

SIDE VIEW

65 (W) x 65 (H) x 57 (D) mm

Mushroom Head STOP Push Button with Push to Lock and Key to Release with 1NC Contact

	Part No.	Price (Rs)
Outdoor	CLCS 006	1,600
Indoor	CLCS 007	1,540

Forward & Reverse START - STOP Push Button

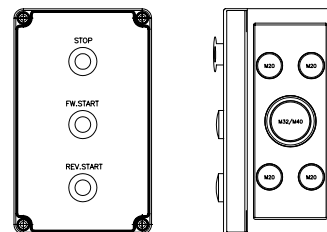

FRONT VIEW

SIDE VIEW

110 (W) x 180 (H) x 90 (D) mm

Blue Actuator flush Head with 1NO "Forward" + Yellow Actuator flush Head, with 1NO "Reserve" + Red actuator Flush Head, with 1NC "stop"

	Part No.	Price (Rs)
Outdoor	CLCS 021	2,755
Indoor	CLCS 022	1,825

START - STOP Push Button

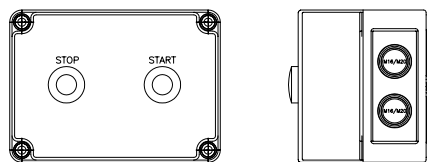

FRONT VIEW

SIDE VIEW

130 (W) x 94 (H) x 81 (D) mm

Green Actuator Flush Head, With 1NO "Start" + Red actuator flush Head with 1NC "Stop"

	Part No.	Price (Rs)
Outdoor	CLCS 011	1,915
Indoor	CLCS 012	1,335

START - STOP Push Button with A/O/M (Or) L/O/R Selector Switch

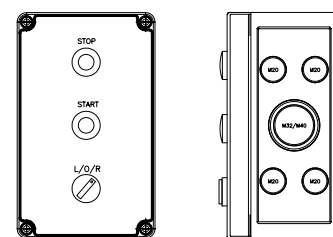

FRONT VIEW

SIDE VIEW

110 (W) x 180 (H) x 90 (D) mm

Green Actuator flush Head with 1NO "Start" + Red Actuator flush Head, with 1NO "Stop" + Selector

	Part No.	Price (Rs)
Outdoor	CLCS 026	3,230
Indoor	CLCS 027	2,305

START - STOP Push Button with Ammeter

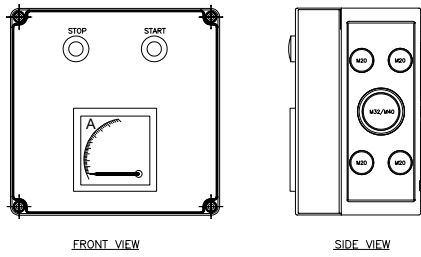

180 (W) x 182 (H) x 111 (D) mm

Green Actuator flush head, with 1NO
"Start" + Red Actuator flush head, with 1NC
"stop", Ammeter

	Part No.	Price (Rs)
Outdoor	CLCS 031	4,815
Indoor	CLCS 032	3,560

Pendant Station

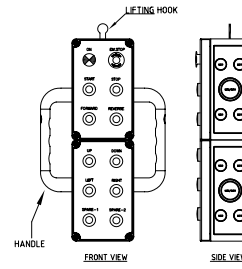

110 (W) x 360 (H) x 90 (D) mm

Emergency Stop (1NC), Start (1NO), Forward / Reverse (1NO) - Black, Up / Down (1NO) - Black, Right / Left (1NO) - Black, Spare - (2NO)

	Part No.	Price (Rs)
Outdoor	CLCS 041	5,895

STOP - START Push Button A/O/M Or L/O/R Selector Switch with Ammeter

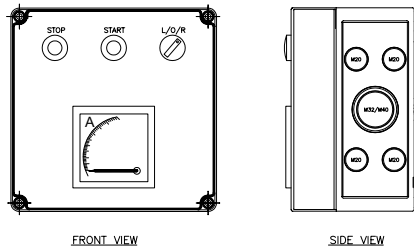

180 (W) x 182 (H) x 111 (D) mm

Green Actuator flush head, with 1NO
"Start" + Red Actuator flush head, with 1NC
"stop", Selector Switch 2 NO, Ammeter

	Part No.	Price (Rs)
Outdoor	CLCS 036	5,590
Indoor	CLCS 037	4,335

Note : Ammeter Range Should be mentioned during the PO Release

Junction Boxes With Terminal Blocks

CAPE Junction Boxes with terminal Blocks are made with Spelsberg Polycarbonate / Polystyrene Enclosures. The Junction Boxes are surface mounting type, IP65. Junction Boxes are compact in size, UV resistant and are suitable for outdoor application. The Knock Out Provision available in 4 Sides of the junction boxes ensure cable entry through all the sides and are completely double insulated to meet industrial safety regulation.

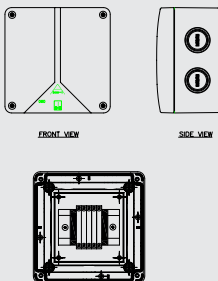

Polystyrene (PS) - Indoor

Sl.No	Terminal Size	No of terminals	Dimension in mm	Part No.	Price (Rs)
1.	2.5 Sqmm	5	93 x 93 x 55	CJB001PS	535
2.	4 Sqmm	5	93 x 93 x 55	CJB002PS	535
3.	6 Sqmm	5	110 x 110 x 67	CJB003PS	885
4.	10 Sqmm	5	140 x 140 x 79	CJB004PS	1,335
5.	16 Sqmm	5	182 x 180 x 111	CJB005PS	1,990
6.	25 Sqmm	5	254 x 180 x 111	CJB006PS	2,800
7.	35 Sqmm	5	254 x 180 x 111	CJB007PS	2,800

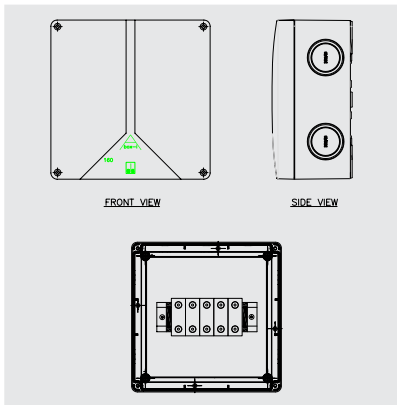

Polycarbonate (PC) - Outdoor					
Sl.No	Terminal Size	No of terminals	Dimension in mm	Part No.	Price (Rs)
1.	2.5 Sqmm	5	93 x 93 x 55	CJB001PC	690
2.	4 Sqmm	5	93 x 93 x 55	CJB002PC	690
3.	6 Sqmm	5	110 x 110 x 67	CJB003PC	1,150
4.	10 Sqmm	5	140 x 140 x 79	CJB004PC	1,620
5.	16 Sqmm	5	182 x 180 x 111	CJB005PC	2,055
6.	25 Sqmm	5	254 x 180 x 111	CJB006PC	3,215
7.	35 Sqmm	5	254 x 180 x 111	CJB006PC	3,215

Meter Enclosures

CAPE Meter Enclosures are made with Spelsberg Polycarbonate / Polystyrene Enclosures. The Meter Enclosures are surface mounting type, IP65. Meter Enclosures are compact in size, UV resistant and are suitable for outdoor application.

Meter Board - 33

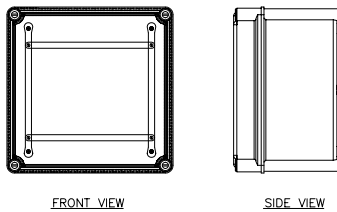

270 (W) x 270 (H) x 170 (D) mm

Part No	Price (Rs)
CMB 001	4,702

Meter Board - 63

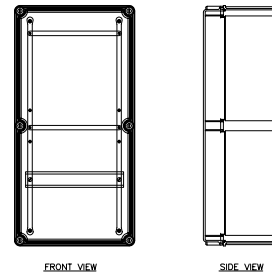

270 (W) x 540 (H) x 170 (D) mm

Part No	Price (Rs)
CMB 016	8,810

Meter Board - 43

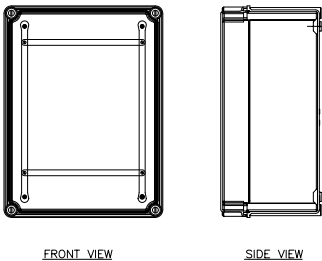

270 (W) x 360 (H) x 170 (D) mm

Part No	Price (Rs)
CMB 005	5,590

Meter Board - 63a

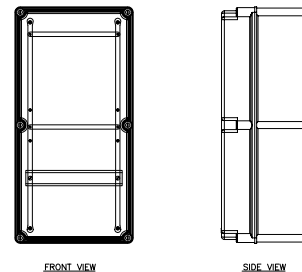

270 (W) x 540 (H) x 205 (D) mm

Part No	Price (Rs)
CMB 021	9,533

Meter Board - 43a

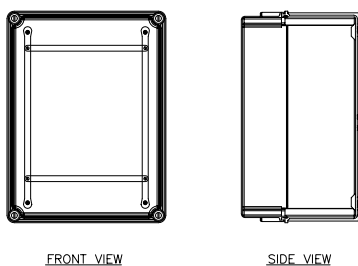

270 (W) x 360 (H) x 205 (D) mm

Part No	Price (Rs)
CMB 011	6,130

Meter Board - 63F

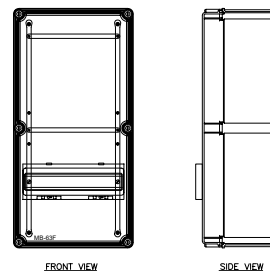

270 (W) x 540 (H) x 170 (D) mm

Part No	Price (Rs)
CMB 026	9,806

Meter Board - 63aF

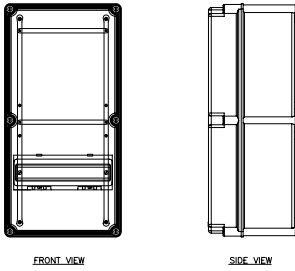

270 (W) x 540 (H) x 205 (D) mm

Part No	Price (Rs)
CMB 031	10,530

Meter Board - 66a

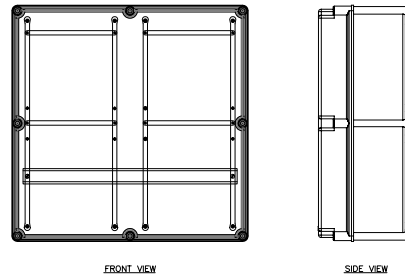

540 (W) x 540 (H) x 205 (D) mm

Part No	Price (Rs)
CMB 036	12,840

Meter Board - 66aF

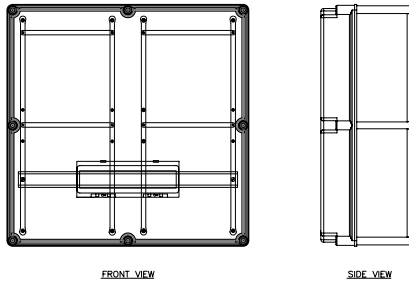

540 (W) x 540 (H) x 205 (D) mm

Part No	Price (Rs)
CMB 041	13,835

CEE Plug & Sockets

CAPE CEE Type Industrial Plug and Sockets boards are made with PCE Plug and Sockets. The Plug & Sockets are available in trailing, wall mounted, flush mounted for both IP44 & IP67. Plug and sockets are fitted with double insulated thermoplastic enclosure to meet industrial safety regulations.

Cape P & S Board - 1818

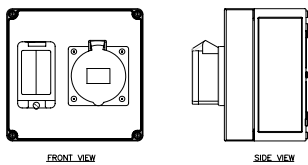

182(W) x 180(H) x 111(D)

		IP44		IP67	
Rating	Qty	Part No	Price (Rs)	Part No	Price (Rs)
16A 3Pin	1	500 001	3,819	600 001	4,733
32A 3Pin	1	500 011	4,485	600 011	5,610

Cape P & S Board - 2518

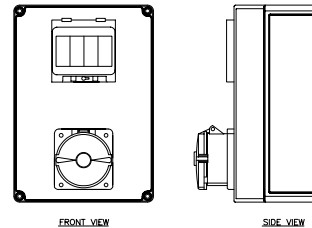

254(W) x 180(H) x 111(D)

		IP44		IP67	
Rating	Qty	Part No	Price (Rs)	Part No	Price (Rs)
16A 5Pin	1	500 006	4,986	600 006	6,290
32A 5Pin	1	500 016	5,665	600 016	6,810

Cape P & S Board - 3625

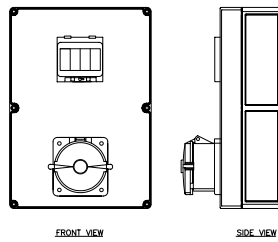

254(W) x 361(H) x 111(D)

IP67

Rating	Qty	Part No	Price (Rs)
63A 5Pin	1	600 021	15,430

Cape P & S Board - 3957

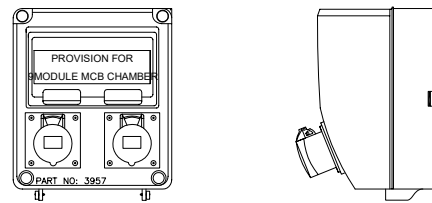

254(W) x 215(H) x 155(D)

IP44

IP67

Rating	Qty	Part No	Price (Rs)	Part No	Price (Rs)
16A 3Pin	2	500 026	5,680	600 026	7,415
32A 5Pin	2	500 031	7,570	600 031	9,755
16A 3Pin	1	500 036	6,305	600 036	8,280
32A 3Pin	1				
16A 3Pin	1	500 041	6,670	600 041	8,700
32A 5Pin	1				
16A 5Pin	1	500 046	7,145	600 046	9,090
32A 5Pin	1				
63A 5 Pin	1			600 047	13,740
Empty Enclosure			2,260		

Cape P & S Board - 3959

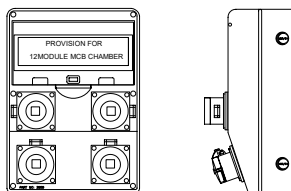

360(W) x 260(H) x 130(D)

IP44

IP67

Rating	Qty	Part No	Price (Rs)	Part No	Price (Rs)
16A 3Pin	2	500 051	10,315	600 051	14,505
16A 5Pin	2				
16A 3Pin	2	500 056	12,260	600 056	16,295
32A 5Pin	2				
16A 3Pin	1	500 061	12,555	600 061	16,520
16A 5Pin	1				
32A 3Pin	1				
32A 5Pin	1				
Empty Enclosure			3,255		

Cape P & S Board - 3977

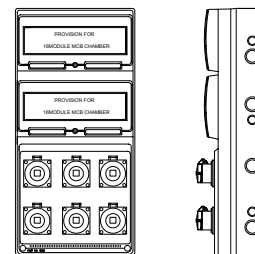

685(W) x 330(H) x 150(D)

IP44

IP67

Rating	Qty	Part No	Price (Rs)	Part No	Price (Rs)
16A 3Pin	4	500 066	16,740	600 066	22,100
16A 5Pin	2				
16A 3Pin	4	500 071	17,325	600 071	23,905
32A 5Pin	2				
16A 3Pin	6	500 076	15,450	600 076	21,700
16A 3Pin	4	500 081	17,255	600 081	22,820
16A 5Pin	1				
32A 5Pin	1				
16A 3Pin	2	500 086	18,275	600 086	24,040
16A 5Pin	2				
32A 3Pin	2				
32A 5Pin	2				
Empty Enclosure			6,282		

Telephone Distribution Box

CAPE Telephone Distribution Boxes are made with Spelsberg Enclosures. The Enclosures are made up of Glass Fiber Reinforced polycarbonate materials and are surface mounting type, IP65. Enclosures are compact in size, Suitable for outdoor application, completely double insulated to meet industrial safety regulations.

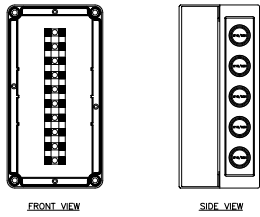

94 (W) x 180 (H) x 81 (D) mm

Part No	Price (Rs)
CTC 10P	2,170

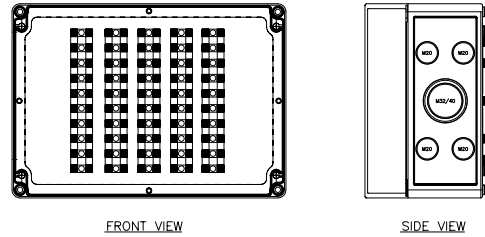

254 (W) x 180 (H) x 111 (D) mm

Part No	Price (Rs)
CTC 50P	4,761

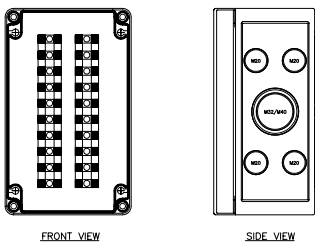

110 (W) x 180 (H) x 90 (D) mm

Part No	Price (Rs)
CTC 20P	2,890

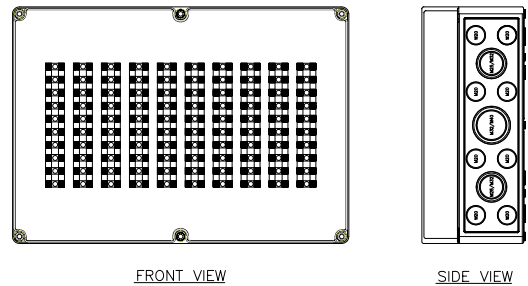

361 (W) x 254 (H) x 111 (D) mm

Part No	Price (Rs)
CTC 100P	9,020

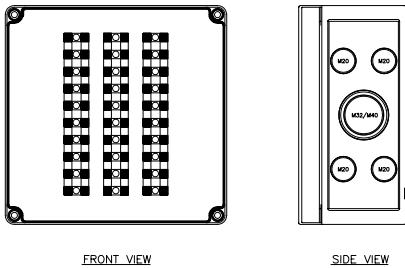

182 (W) x 180 (H) x 90 (D) mm

Part No	Price (Rs)
CTC 30P	3,933

Our Esteemed Clients....



Terms and Conditions :

- Price : Ex-Works Oragadam
- GST : GST / Levies extra as applicable
- Insurance : Goods will get dispatched duly insured
- Freight : Freight to be borne by the customer
- Place of Jurisdiction : Chennai

The above prices are subject to change without notice

Authorised Channel Partner :

CAPE
ELECTRIC

Cape Electric Pvt Ltd

Plot A-41B, SIPCOT,
Oragadam, Sriperumbudur Taluk,
Kancheepuram District - 602 105
Tel : 044 - 7101 8100 - 10
Fax : 044 - 7101 8199
Email Id : sales@capeindia.net
Web : www.capeindia.net

